

LA36M产品TYPE.C系列

Compact Range



浙江风向标电气有限公司

VaneAims Electrical Co.,Ltd

按钮开关Φ22

LA36M-C系列按钮开关



型号及含义 TYPE AND MEANING

LA36M - C 1 2 3 / 4 5 6

头部类型
Operators
设计序号 Design serial number
按钮开关型号
Push button code

1 表示常开触头 NO contact

2 表示常闭触头 NC contact

4 表示颜色及旋钮钥匙钮动作功能和拔出位置
Color, selector button and keylock button operation function and pulling out position

红	绿	黄	蓝	白	黑
R	G	Y	B	W	K

动作功能 spring return action		
f	fu	ffu
左自复 left to centre	右自复 right to centre	左右自复 Left-right to centre

5 电压(Voltage)

21-DC.AC 6V	26-DC.AC 110V
22-DC.AC 12V	27-DC.AC 127V
23-DC.AC 24V	28-DC 220V
24-DC.AC 36V	31-AC 220V
25-DC.AC 48V	32-AC 380V

6 标志钮符号代码 (Code of push button symbol)

1	2	3	4	5	6
7	8	9	10	11	12

使用环境条件 WORKING ENVIRONMENT

周围空气温度 -25℃ ~ +40℃; Ambient air temperature -25℃ ~ +40℃.
海拔高度 ≤ 2000m; Altitude: ≤ 2000m.
空气相对湿度 ≤ 90%; Relative air humidity: ≤ 90%.
污染等级 3 级; Pollution degree: class 3.
防护等级 IP40/IP65; Protection degree: IP40/IP65.

主要技术参数 MAIN TECHNICAL PARAMETER

开关额定值 Rated value of switch: AC-15 36V/10A 110V/10A 220V/5A 380V/2.7A 660V/1.8A
DC-13 24V/4A 48V/4A 110V/2A 220V/1A 440V/0.6A.

约定发热电流 Conventional thermal current: Ith 10A.

触点电阻 Contact resistance: ≤ 50mΩ

绝缘电阻 Insulation resistance: ≥ 10MΩ

机械寿命 Mechanical durability: 一般按钮 Common push-button ≥ 100 × 10⁴次 times; 旋钮 Selector button ≥ 30 × 10⁴次 times.
钥匙按钮 Key push-button ≥ 5 × 10⁴次 times; 紧急按钮 Emergency push-button ≥ 5 × 10⁴次 times.

3 表示机械形式 Mechanical form

字母 letter	含义 Implication
	平按钮 Flush push button
D	带灯按钮 Illuminated push button
T	自锁按钮 Maintained push button
TD	带灯自锁按钮 Illuminated Maintained push button
M	蘑菇按钮 Mushroom push button
MD	带灯蘑菇按钮 Illuminated Mushroom button
MT	自锁蘑菇按钮 Maintained Mushroom button
MTD	带灯自锁蘑菇按钮 Illuminated Maintained Mushroom button
ZS	急停按钮 Emergency stop button
Y	二位钥匙按钮 2-Position keylock selector
YS	三位钥匙按钮 3-Position keylock selector
X	短柄二档旋钮 2-Position short lever selector
XD	带灯短柄二档旋钮 Illuminated 2-Position short lever selector
XS	短柄三档旋钮 3-Position short lever selector
XSD	带灯短柄三档旋钮 Illuminated 3-Position short lever selector
CX	长柄二档旋钮 2-Position long lever selector
CXD	带灯长柄二档旋钮 Illuminated 2-Position long lever selector
CXS	长柄三档旋钮 3-Position long lever selector
CXSD	带灯长柄三档旋钮 Illuminated 3-Position long lever selector
RG	双位按钮 Dual push button
DRG	带灯双位按钮 Illuminated dual push button
H	高位按钮 Extended push button
HD	带灯高位按钮 Illuminated extended push button
HT	自锁高位按钮 Maintained extended push button
HTD	带灯自锁高位按钮 Illuminated Maintained extended push button
FH	平按钮带符号 Flush button marked

按钮开关Φ22

LA36M-C系列按钮开关



描述 Description 颜色color 尺寸size



自复型 Momentary
LA36M-C-10
自锁型 Maintained
LA36M-C-10T

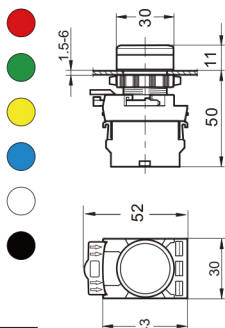

自复型 Momentary
LA36M-C-10/FH○
自锁型 Maintained
LA36M-C-10T/FH○
带灯自复型 Momentary Illuminated
LA36M-C-10D/FH○
带灯自锁型 Maintained Illuminated
LA36M-C-10DT/FH○



两档自锁型 Maintained 2-Position
LA36M-C-10CX
两档自复型 Momentary 2-Position
LA36M-C-10CX/fu
三档自锁型 Maintained 3-Position
LA36M-C-20CXS
三档自复型 Momentary 3-Position
LA36M-C-20CXS/f.fu

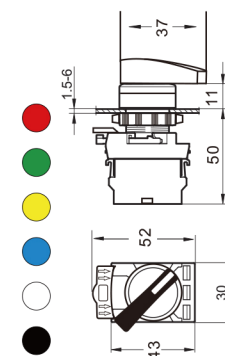

带灯自锁型 Maintained Illuminated
2-Position
LA36M-C-10CXD
带灯自复型 Momentary Illuminated
2-Position
LA36M-C-10CXD/fu
带灯自锁型 Maintained Illuminated
LA36M-C-20CXSD
带灯自复型 Momentary Illuminated
LA36M-C-20CXSD/f.fu

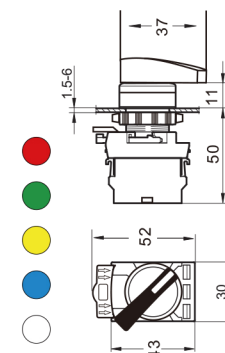

描述 Description 颜色color 尺寸size



带灯自复型 Momentary Illuminated
LA36M-C-10D
带灯自锁型 Maintained Illuminated
LA36M-C-10DT

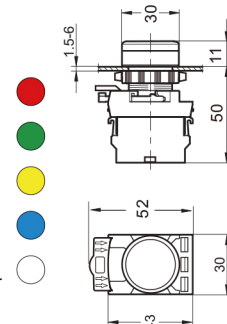

自复型 Momentary
LA36M-C-10M
自锁型 Maintained
LA36M-C-10MT
带灯自复型 Momentary Illuminated
LA36M-C-10MD
带灯自锁型 Maintained Illuminated
LA36M-C-10MTD

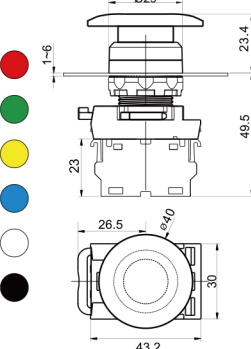

两档自锁型 Maintained 2-Position
LA36M-C-10X
两档自复型 Momentary 2-Position
LA36M-C-10X/fu
三档自锁型 Maintained 3-Position
LA36M-C-20XS
三档自复型 Momentary 3-Position
LA36M-C-20XS/f.fu

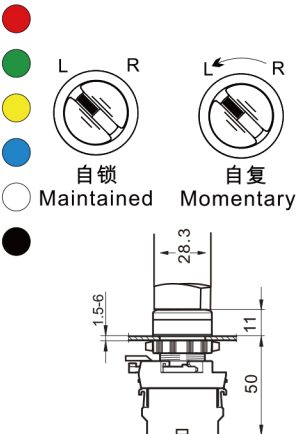

带灯自锁型 Maintained Illuminated
2-Position
LA36M-C-10XD
带灯自复型 Momentary Illuminated
2-Position
LA36M-C-10XD/fu
带灯自锁型 Maintained Illuminated
LA36M-C-20XSD
带灯自复型 Momentary Illuminated
LA36M-C-20XSD/f.fu

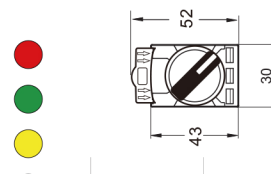

Maintained
自锁

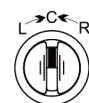

Momentary
From R to C
From L to C
由右至中和
由左至中自复

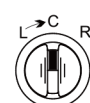

Momentary
From L to C
由左至中自复

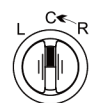

Momentary
From R to C
由右至中自复

按钮开关Φ22

LA36M-C系列按钮开关



描述 Description 颜色color 尺寸size



两档自锁型 Maintained 2-Position
LA36M-C-10Y

三档自锁型 Maintained 3-Position
LA36M-C-20CYS

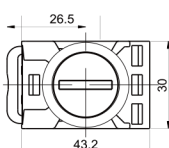
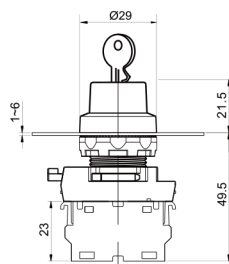

两档自锁型 Maintained 2-Position
LA36M-C-10CY

两档自复型 Momentary 2-Position
LA36M-C-10CY/fu

三档自锁型 Maintained 3-Position
LA36M-C-20CYS

三档自复型 Momentary 3-Position
LA36M-C-20CYS/f.fu

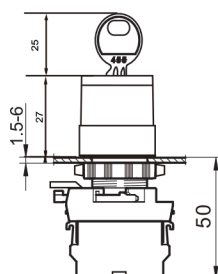

旋转释放 Twist Release
不带灯型 Non-illuminated

LA36M-C-01ZS

旋转释放 Twist Release
带灯型 illuminated

LA36M-C-01DZS

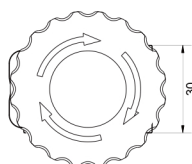
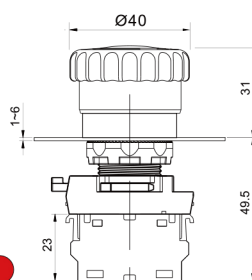

旋转释放 Twist Release
不带灯型 Non-illuminated

LA36M-C-01ZS/A

旋转释放 Twist Release
带灯型 illuminated

LA36M-C-01DZS/A

描述 Description 颜色color 尺寸size



不带灯自复型 Momentary
Non-illuminated

LA36M-C-11PRG

带灯自复型 Momentary
Illuminated

LA36M-C-11PDRG

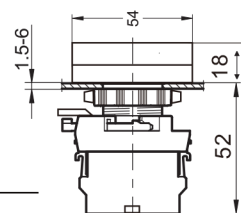

不带灯自复型 Momentary
Non-illuminated

LA36M-C-11HRG

带灯自复型 Momentary
Illuminated

LA36M-C-11HDRG

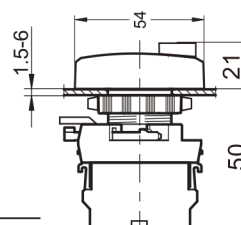
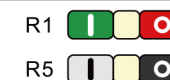

不带灯自复型 Momentary
Non-illuminated

LA36M-C-11RG

带灯自复型 Momentary
Illuminated

LA36M-C-11DRG

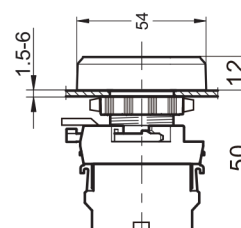
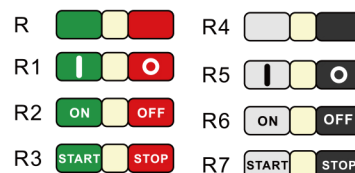

旋转释放 Twist Release
不带灯型 Non-illuminated

LA36M-C-01ZS/B

